

An aerial photograph of a city, likely St. Louis, showing a dense grid of streets, buildings, and green spaces. A river, the Mississippi River, flows through the city, and a major highway, I-95, is visible. The image is in black and white, with a dark purple overlay on the right side containing the text.

# **BRIDGING I-95: CONNECTING THE COMMUNITY**

CAP FEASIBILITY STUDY  
ADVISORY COMMITTEE  
MEETING #2 08 MARCH 2022





## AGEND

**A** Welcome

+ Presentation

- + Where We Have Been
- + Community Engagement Outcomes
- + Project Considerations
- + Project Goals
- + Early Approaches

+ Discussion

# I-95 FEASIBILITY

*STUDY We have Been*



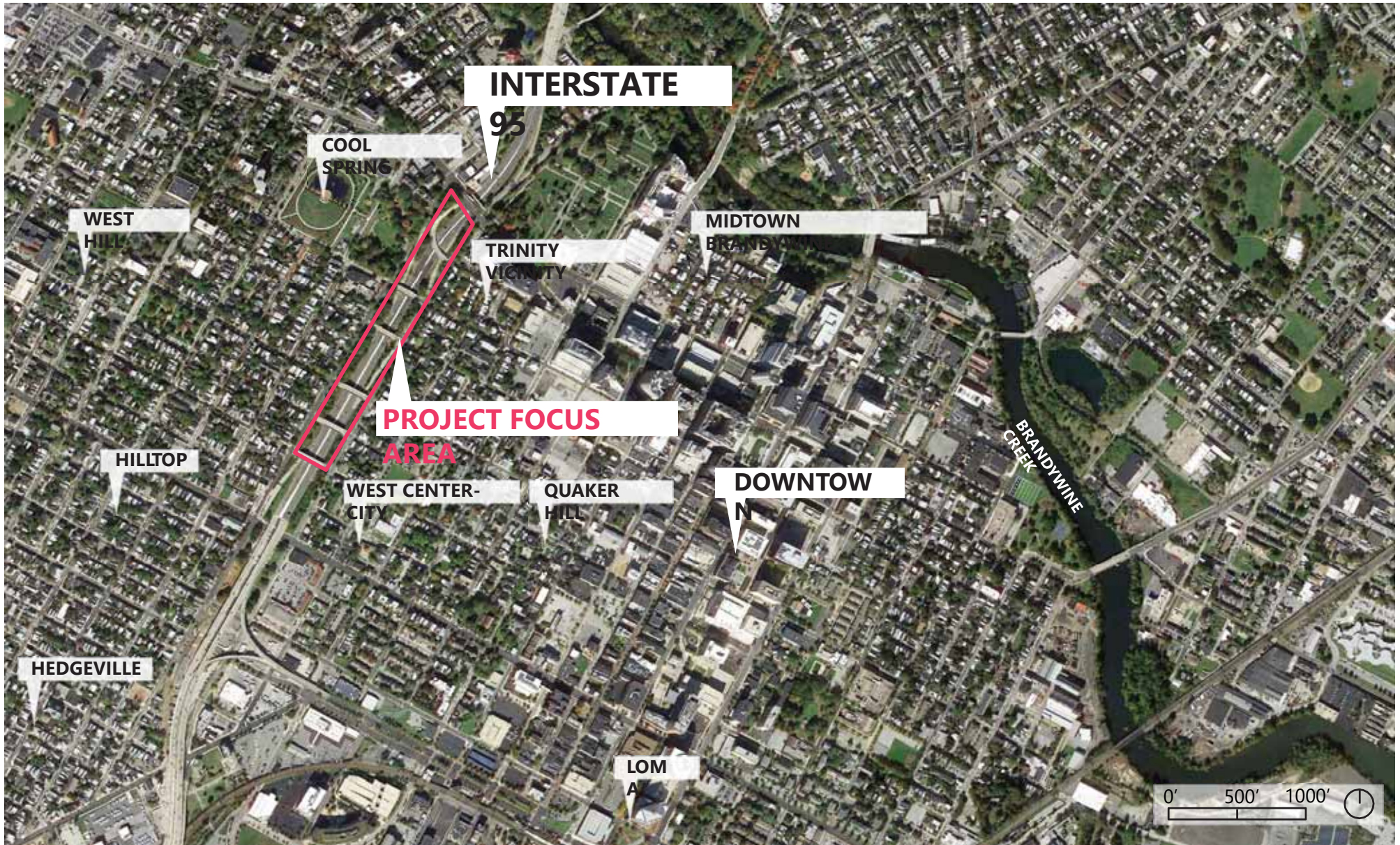











Advisory Committee Meeting #1 Activity (September 30th & November 2nd 2021)

**What would make this project successful?**

*Write one word or phrase that describes your optimism*

*Trip generator*

*Community restorations*

*Life and energy*

*Amenities for*

*the Improve air quality*

*neighborhoods*

*Bring together different communities*

*A project appreciated by locals*

*Connections of*

*Include those experiencing  
homelessness*

*people and places*

*Universally accessible*

*A place for teens*



## Community Workshops #1 and #1B (November 17th 2021 & January 12th 2022)

### Let's talk about the the area.

#### *What is working?*

*Local Artwork (Bridge murals) Diversity*

*Community Gardens*

*Local Business and*

*Entrepreneurship*

*Involved communities, leaders, and politicians*

#### *What is **not** working?*

*Not enough public trash cans*

*Cars have more access and right of way than pedestrians*

*Lack of lighting*

*Localized Flooding*

*Not enough bike-able and walkable connections*



## Community Workshops #1 and #1B (November 17th 2021 & January 12th 2022)

### Let's make a vision for the future of I-95

*When I picture the future of this place, I envision...*

*When picturing the future of this place, the community envisions **a place for everyone** that is **safe, walkable, and colorful**.*

*This includes **well-lit, well-maintained programmed areas** that prioritize **sustainability, native plantings**, places for families and community members to **play** and **exercise** comfortably, and that **celebrates the history of the neighborhoods**.*





Where do you walk or bike? Where **would you walk or bike**, if you could?

 I WANT TO BIKE HERE



## Community Workshops #1 and #1B (November 17th 2021 & January 12th 2022)

Where do you walk or bike? Where **would you walk or bike**, if you could?

 I CURRENTLY WALK HERE

 I WANT TO WALK HERE

 I CURRENTLY BIKE HERE

 I WANT TO BIKE HERE

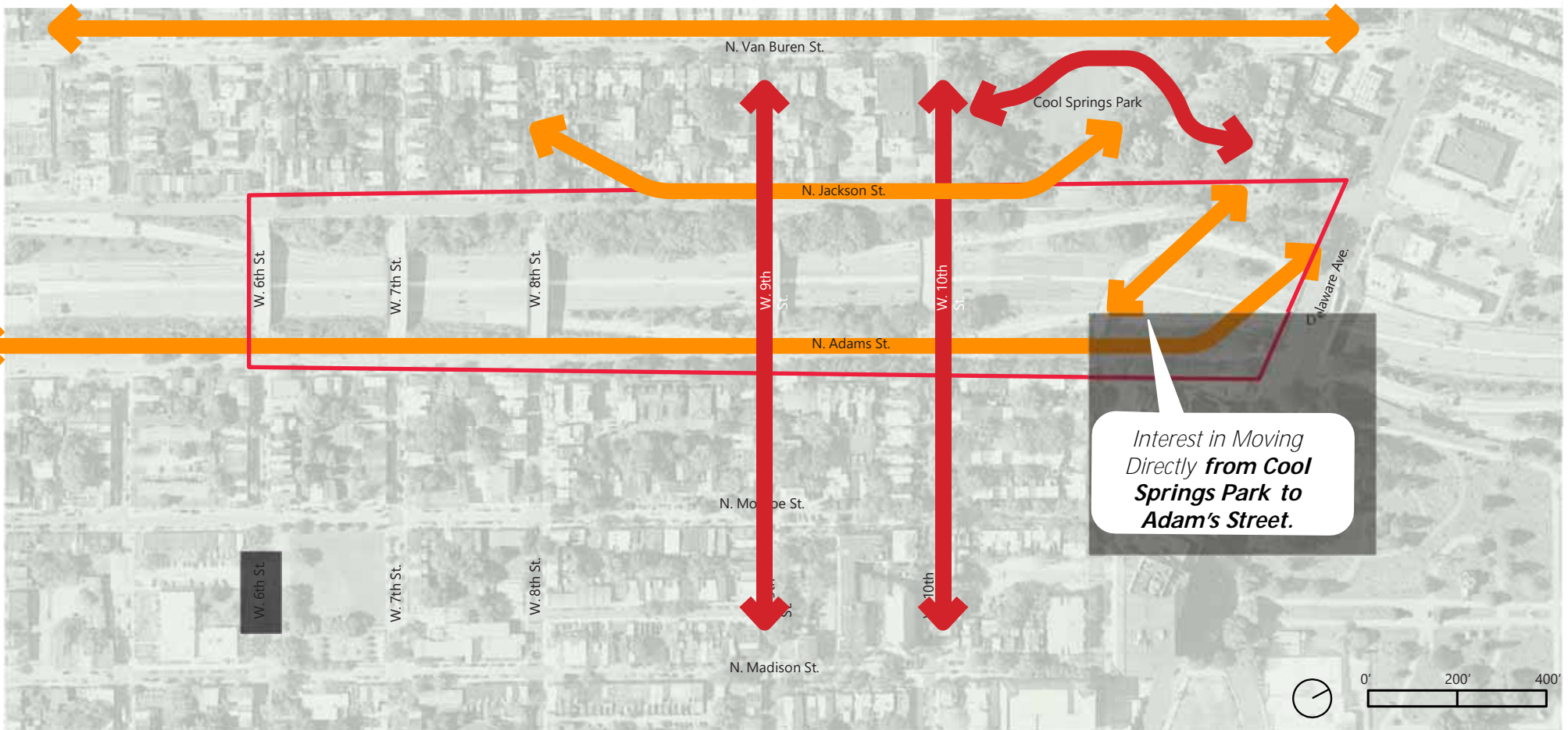



Where do you walk or bike? Where **would you walk or bike**, if you could?

 I WANT TO BIKE HERE

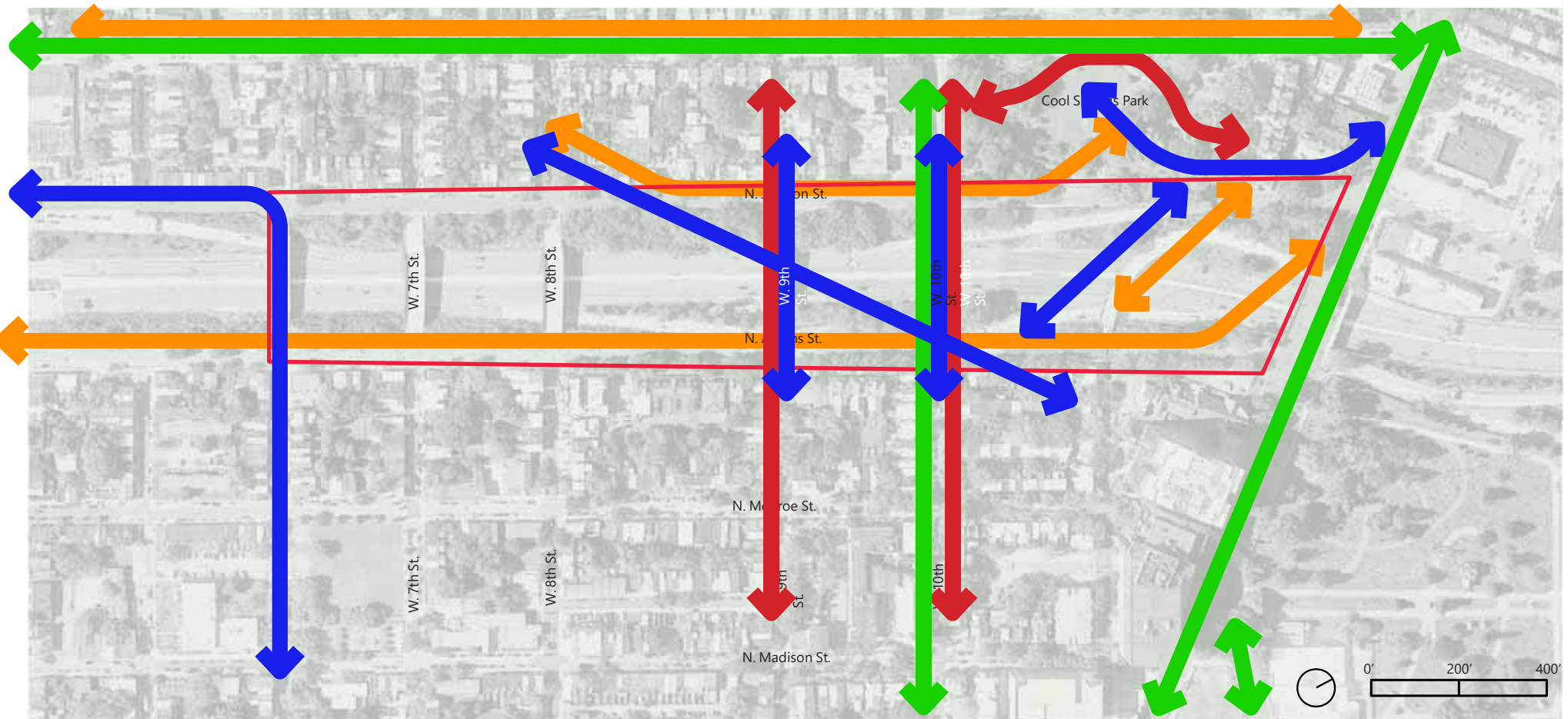







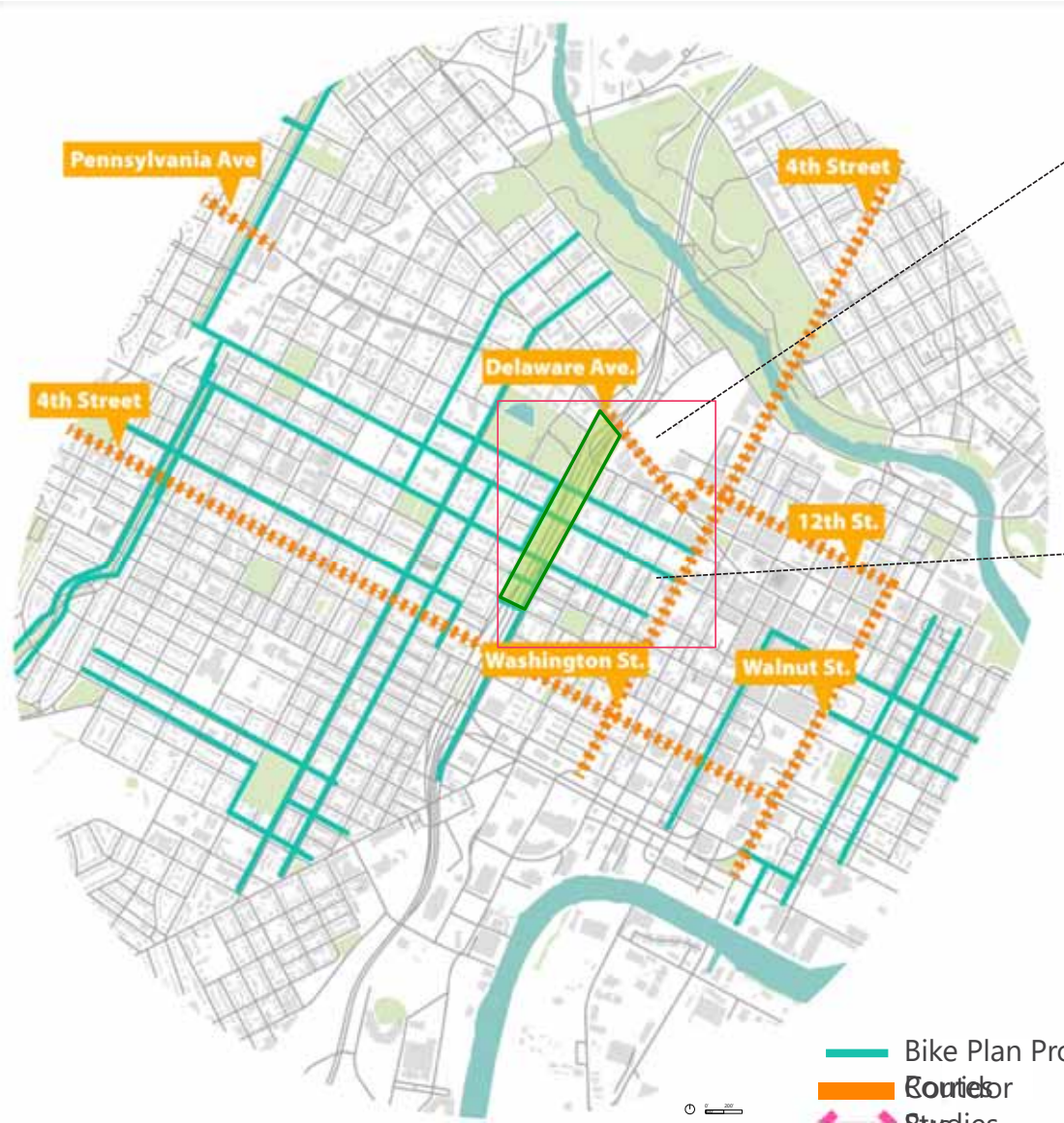

- Bike Plan Proposed
- Routes
- ↔ Studies Route



# City Of Wilmington Bike Plan



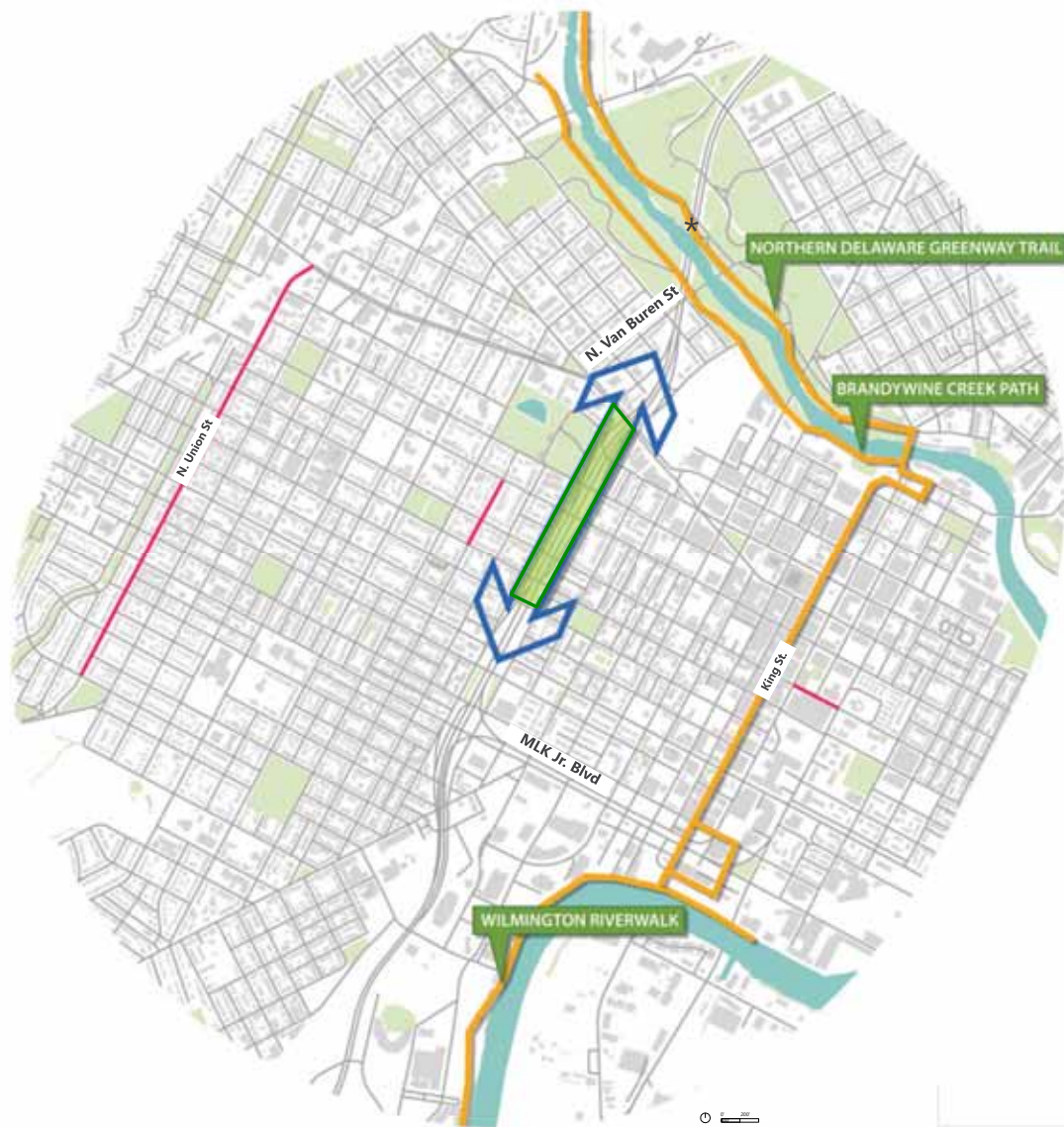

## Brandywine to River Connections



Brandywine Creek Path

Image:  
TrailLink

- Existing Bike Trail
- Existing Bike Lane
- Bike Plan Proposed Routes
- Possible Bike Route Extension





SITE  
TOPOGRAPHY

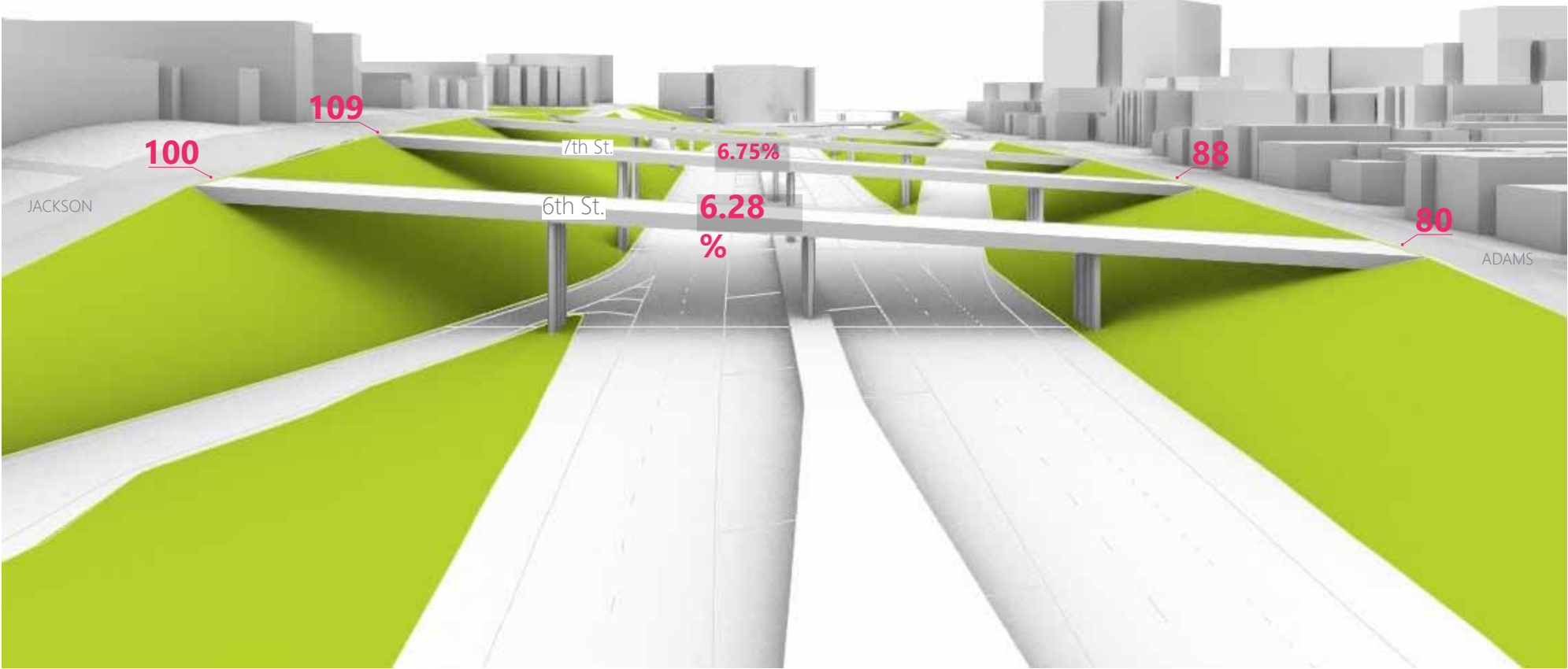

SITE  
TOPOGRAPHY

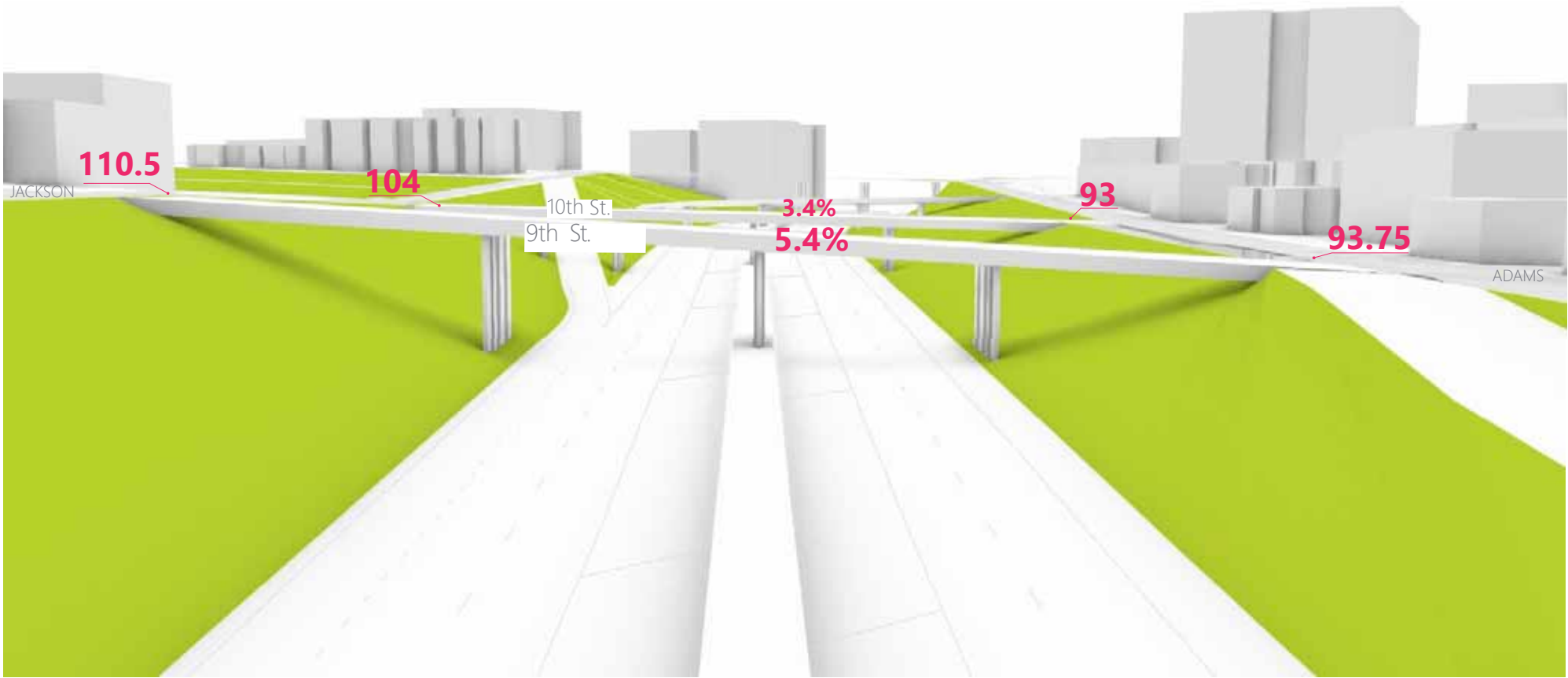



SCALE COMPARISONS | The Commons, Minneapolis, MN

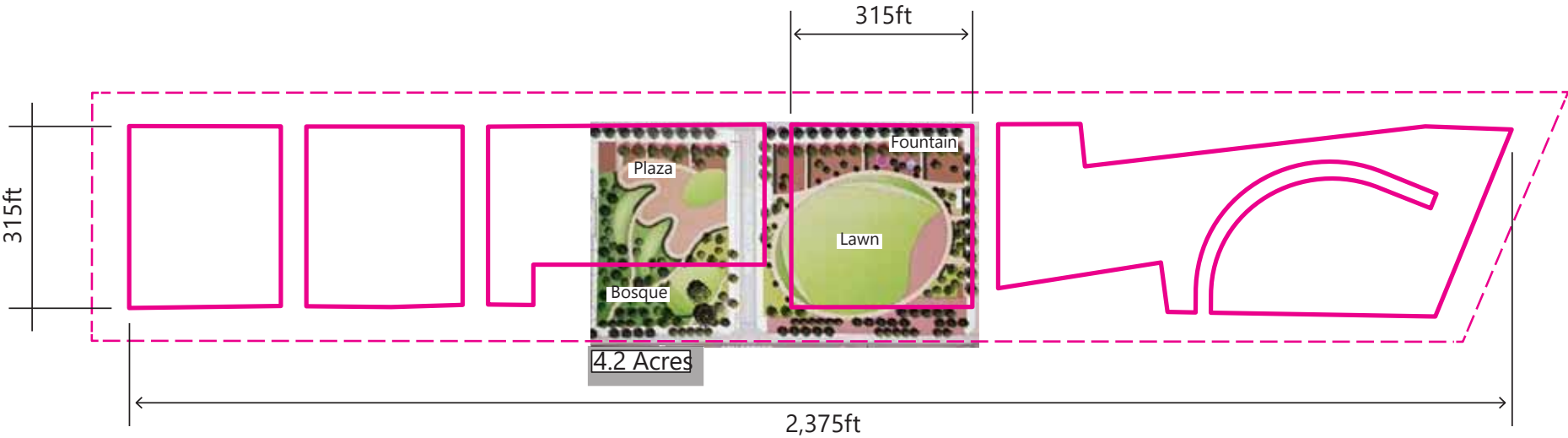

SCALE COMPARISONS | Klyde Warren Park, Dallas, TX

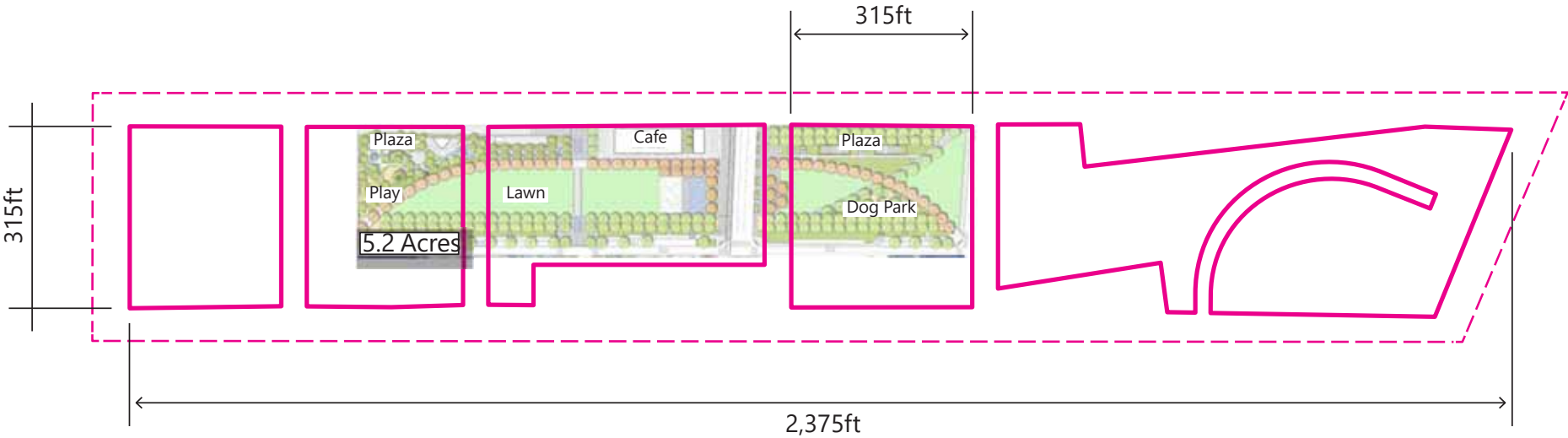



SCALE COMPARISONS | Civic Park, Dallas, TX

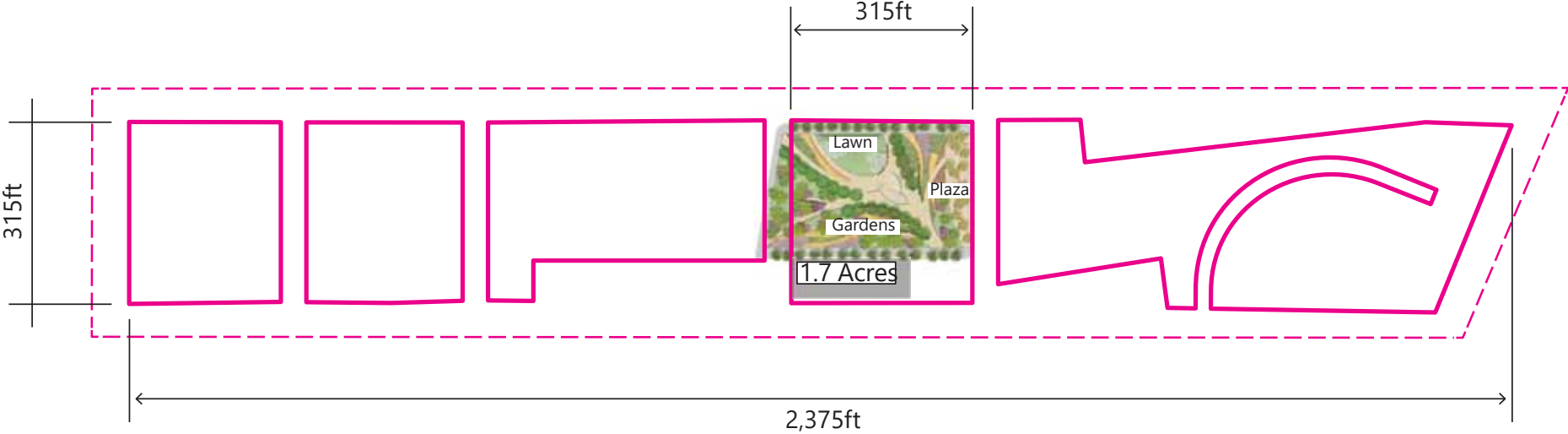

SCALE COMPARISONS | Discovery Green, Houston, TX

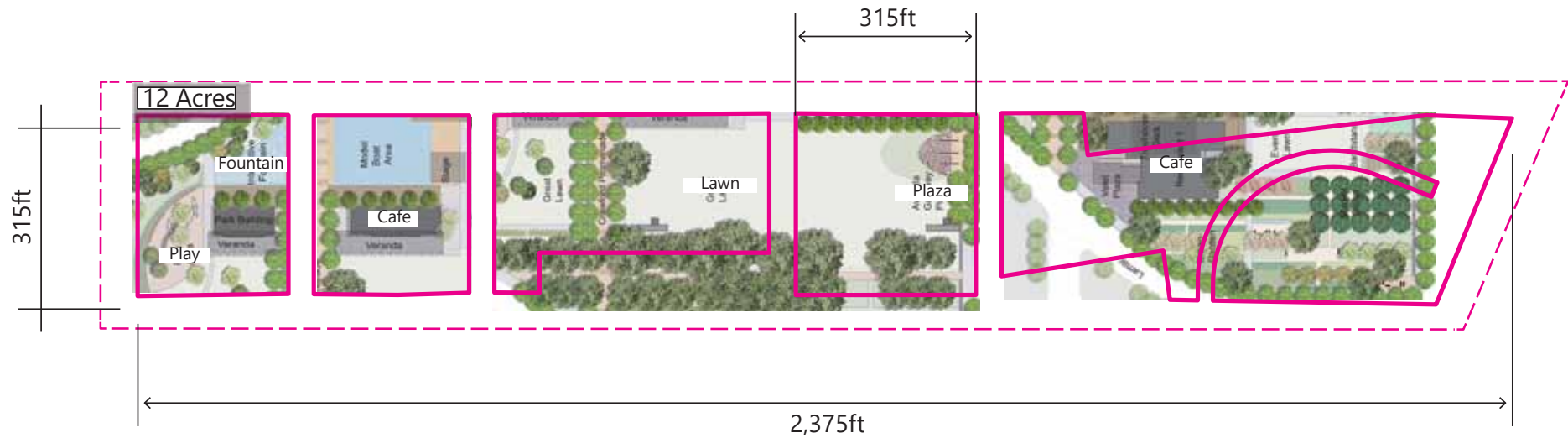



An aerial photograph of a city, likely Los Angeles, with a green outline highlighting a specific area in the center. The image is overlaid with a dark purple semi-transparent rectangle containing the title text.

# **I-95 FEASIBILITY STUDY**

## *Project Goals*

## PROJECT GOALS

**Reconnect** the neighborhoods divided by the construction of I-95 within the Jackson-Adams Corridor between the Delaware Avenue Bridge and the 6th Street Bridge.

**Support** neighborhood character, cohesion, and pride.

**Provide** equitable, safe, and connected access for pedestrians and people riding bicycles and using all modes of transportation.

**Create** inclusive, welcoming, vibrant public urban outdoor experiences through public realm & landscape amenities for residents of the adjacent neighborhoods.

### GIVENS

---

- No commercial or residential relocations.
- Maintain an acceptable level of traffic flow through the project area balanced with a safe pedestrian oriented environment.
- No significant reconfiguration of I-95.



## PROJECT PURPOSE

The purpose of this project is to mitigate the severed community connectivity between the neighborhoods adjacent to I-95 through **inclusive, vibrant public realm** and **landscape amenities** that celebrate neighborhood histories and to provide equitable and safe access to these new amenities through a **comfortable, safe, and connected multimodal network**.

## PROJECT NEED

This project is needed to **offset the social and physical damage** caused by the initial construction of I-95 during the 1960's which **severed connectivity and cohesion** between communities adjacent to I-95 and created uncomfortable and **unsafe conditions** for people walking, biking, and traveling at night due to **inadequate multimodal access** between neighborhoods.

# UNDERSTANDING TRAFFIC CONDITIONS

Closing 8th and 9th Streets

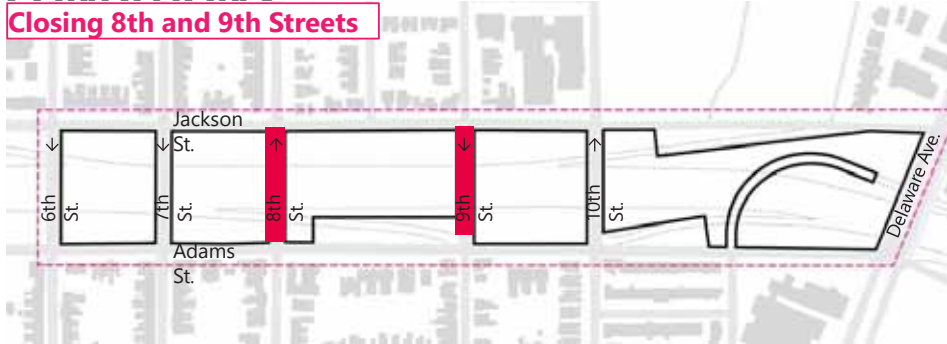

Closing 8th and 10th Streets



Closing 7th Street

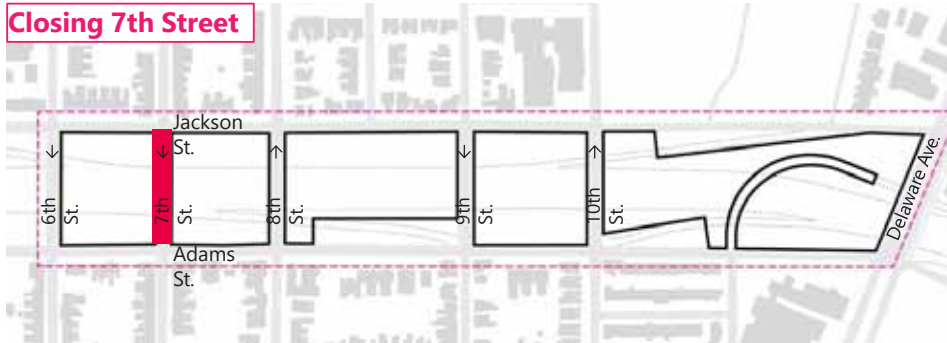

Closing 9th and 10th Streets



Closing 7th and 8th Streets

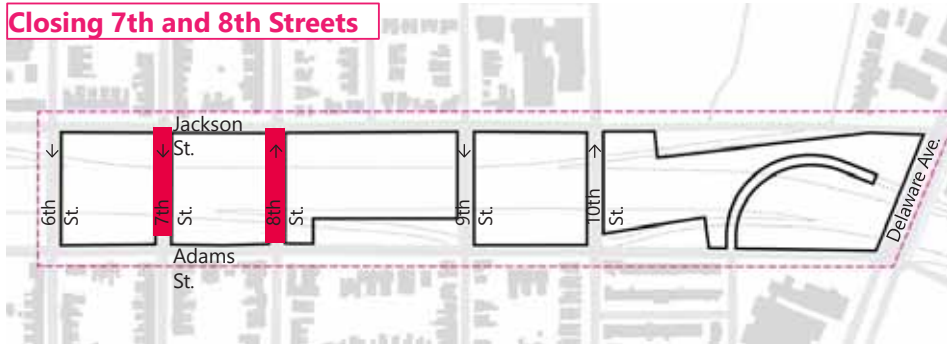

Closing 10th Street On Ramp

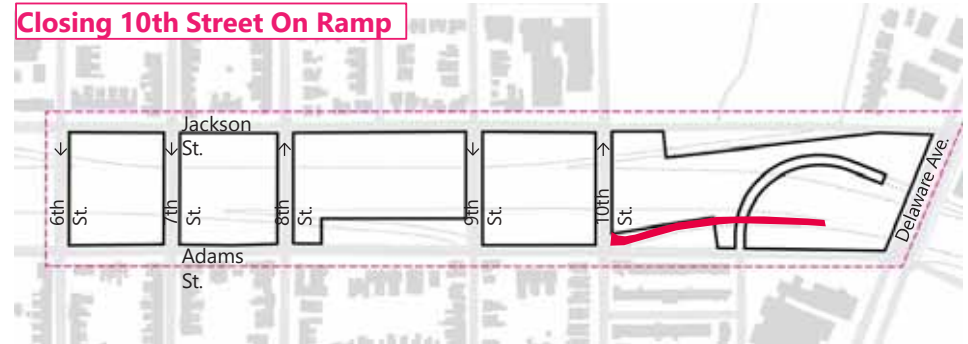



An aerial photograph of a city, likely Philadelphia, showing a dense urban landscape with various buildings, streets, and green spaces. A green outline is drawn on the image, indicating a proposed corridor for a highway, specifically I-95. The corridor starts near a baseball field and runs through the city towards the top right. A large black rectangular box is overlaid on the center of the image, containing the title text.

# **I-95 FEASIBILITY STUDY**

*Early Approaches*

# APPROACH 01 | OUTDOOR ROOMS

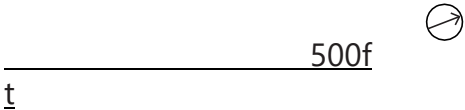
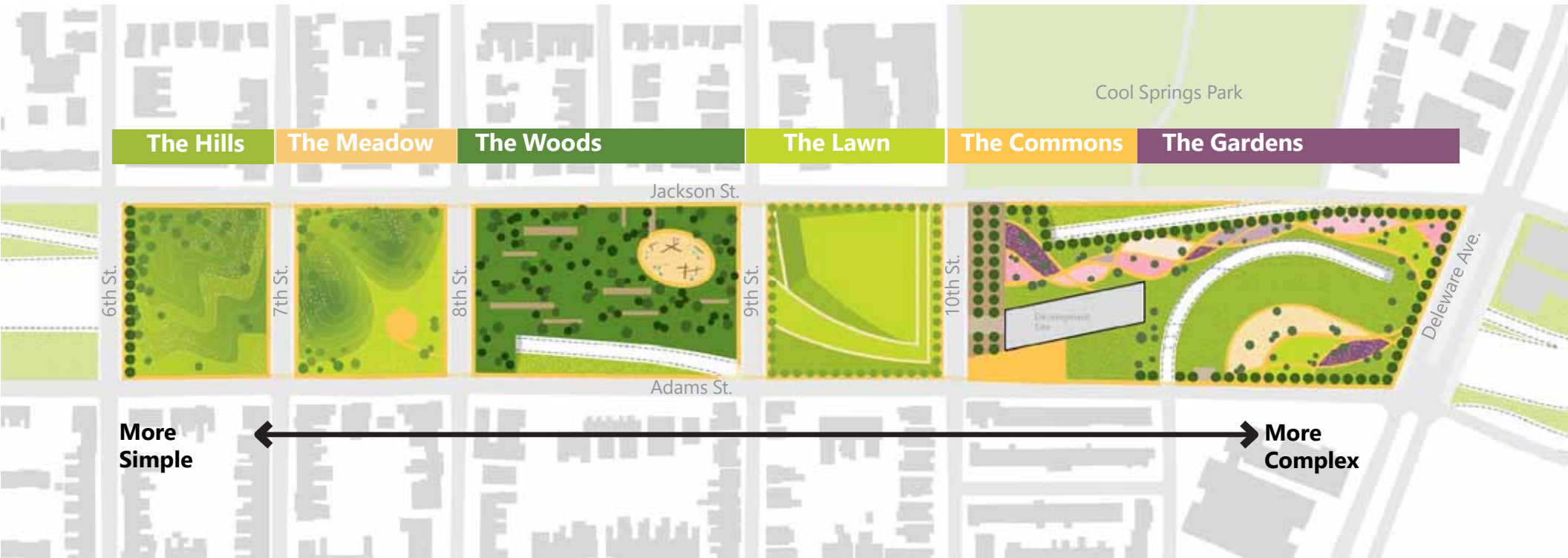
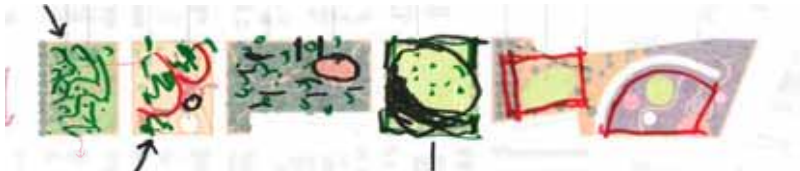



# APPROACH 01 | OUTDOOR ROOMS

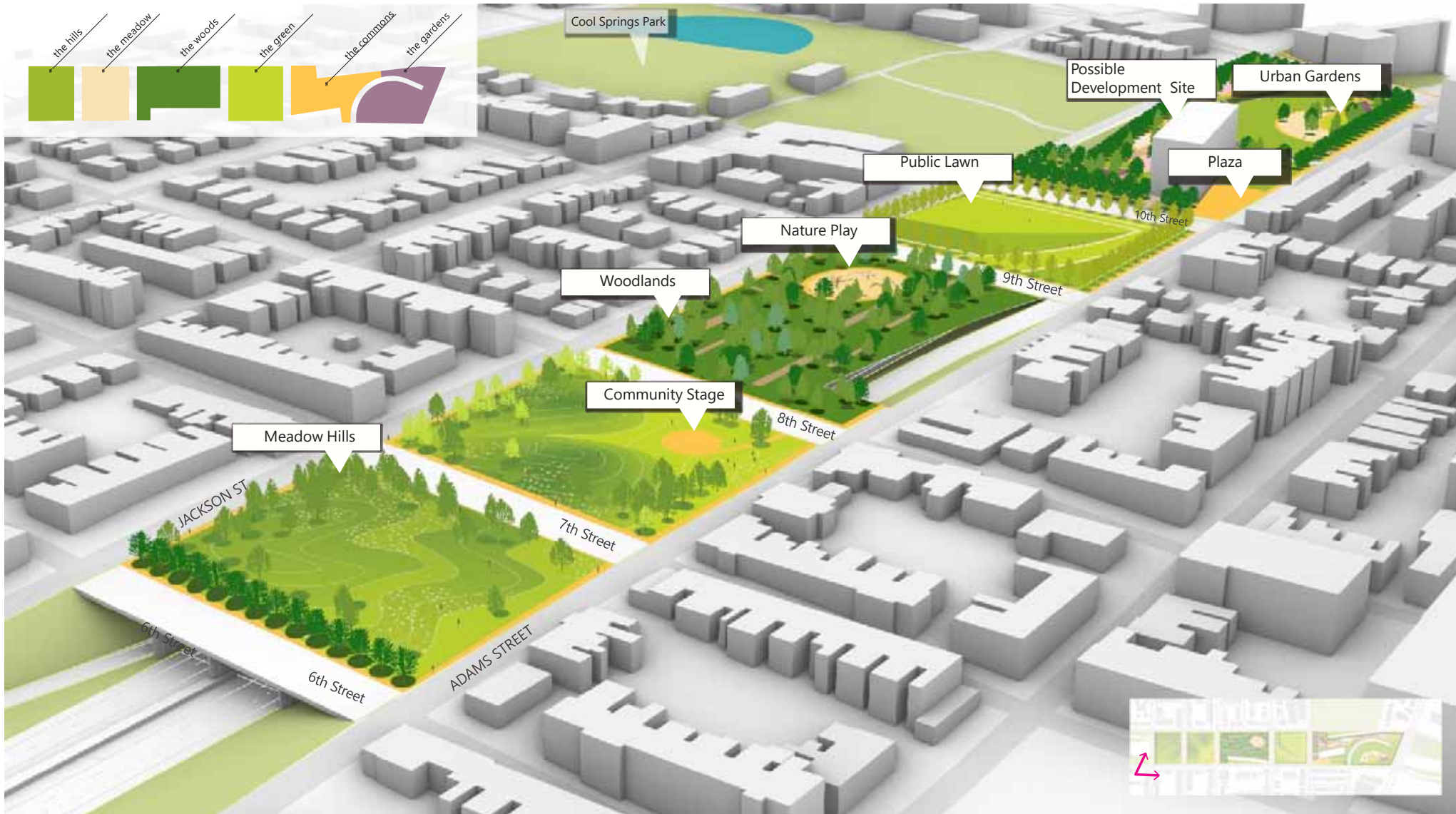



# APPROACH 02 | GREENWAY

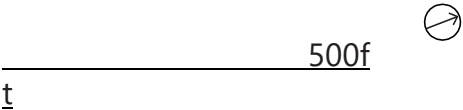
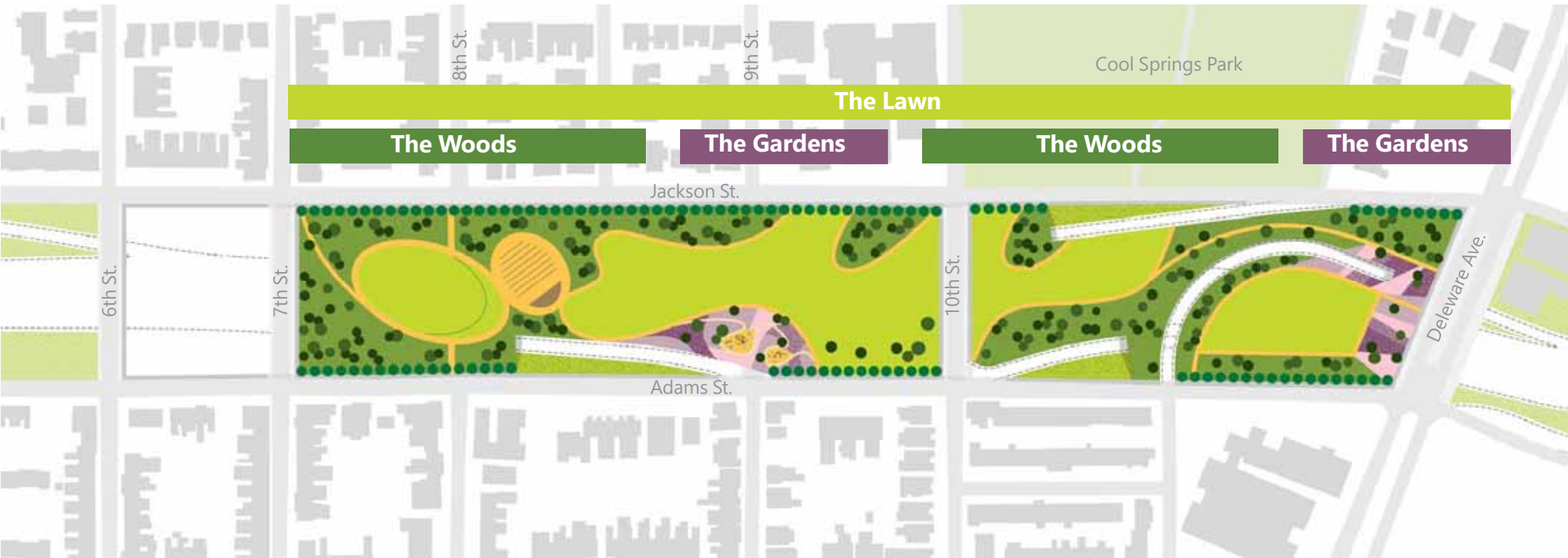
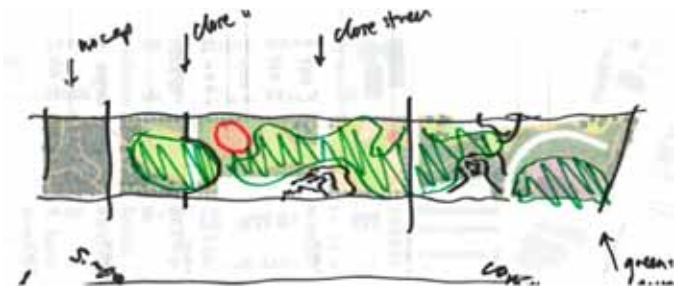

# APPROACH 02 | GREENWAY



# APPROACH 03 | THE COMMONS

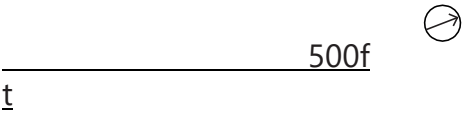
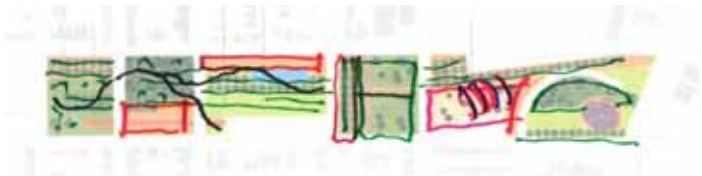



# APPROACH 03 | THE COMMONS



## Early Approach 1: Outdoor Rooms

*a series of distinct places*

- All Streets Remain Open
- Includes Development Site
- Closes 10th St. Ramp



## Early Approach 2: Greenway

*a contiguous public green*

- 8th and 9th Close to Cars
- Excludes 6th-7th Street Span



## Early Approach 03: The Commons

*a cohesive civic space*

- All Streets Remain Open
- All Approaches are Phaseable





An aerial photograph of a city, likely San Francisco, showing a dense urban landscape with a mix of residential and commercial buildings, trees, and a baseball stadium. A major highway interchange is visible in the upper right portion of the image. A semi-transparent black rectangular box is centered over the middle of the image, containing white text.

# **I-95 FEASIBILITY STUDY** *NEXT STEPS & SCHEDULE*



## NEXT STEPS

Community Workshop #2

Refine Early Approaches

Targeted Community

Outreach

- How can we better engage with more neighborhoods?
- What model of engagement would be most effective in your neighborhood?
- Where would it be most effective (grocery store, parks, etc)?



## TASK 1

COMMUNITY VISIONING

## TASK 2

DEFINE ASSUMPTIONS AND  
CREATE INITIAL CONCEPTS FOR  
ANALYSIS

## TASK 3

ASSESS FEASIBILITY OF ALL  
CONCEPTS

## TASK 4

SELECT PREFERRED CONCEPT  
& COMPLETE FINAL REPORT

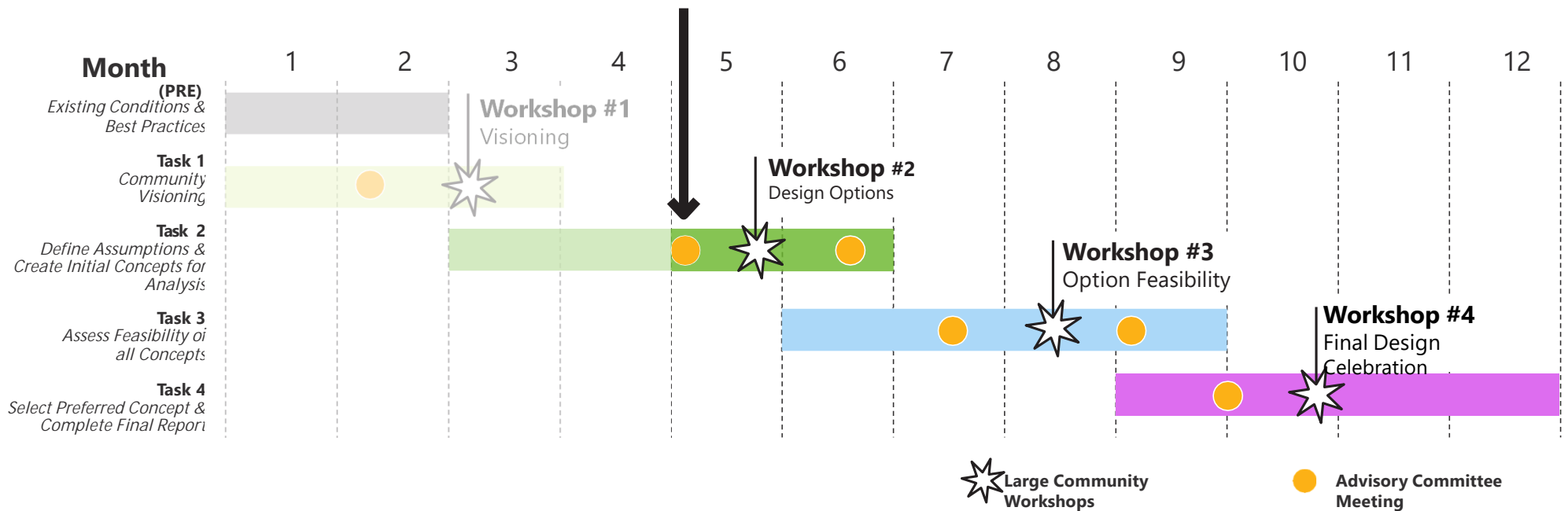



Please take our quick survey on the project website:

<http://www.wilmapco.org/i95cap/>

Questions or Comments? Please contact Dave Gula [dgula@wilmapco.org](mailto:dgula@wilmapco.org)

