

### COMMON SENSE APPLICATIONS FOR EVERYDAY MOBILITY PROBLEMS

#### NEW APPLICATION FOR UNSIGNALIZED CROSSWALKS



What Drivers See	What Pedestrians See
1. <b>DARK</b>	Push the button.
2. <b>FLASHING</b>	
3. <b>STEADY</b>	
4. <b>STEADY</b>	Start crossing.
5. <b>ALTERNATING</b> (like RXR) Stop. Then go if clear.	<b>FLASHING</b> Continue crossing.
6. <b>DARK</b>	

H.A.W.K. Signal Beacon

#### ENHANCED CROSSWALK DESIGNS

Current AASHTO Standard	Recommended Design
<p>142°</p> <p>30° 30°</p> <p>high speed, low visibility, head turner</p>	<p>112°</p> <p>Angle 55-60°</p> <p>30° 20°</p> <p>14-18 mph, good visibility</p>

Improved Right-turn Alignment

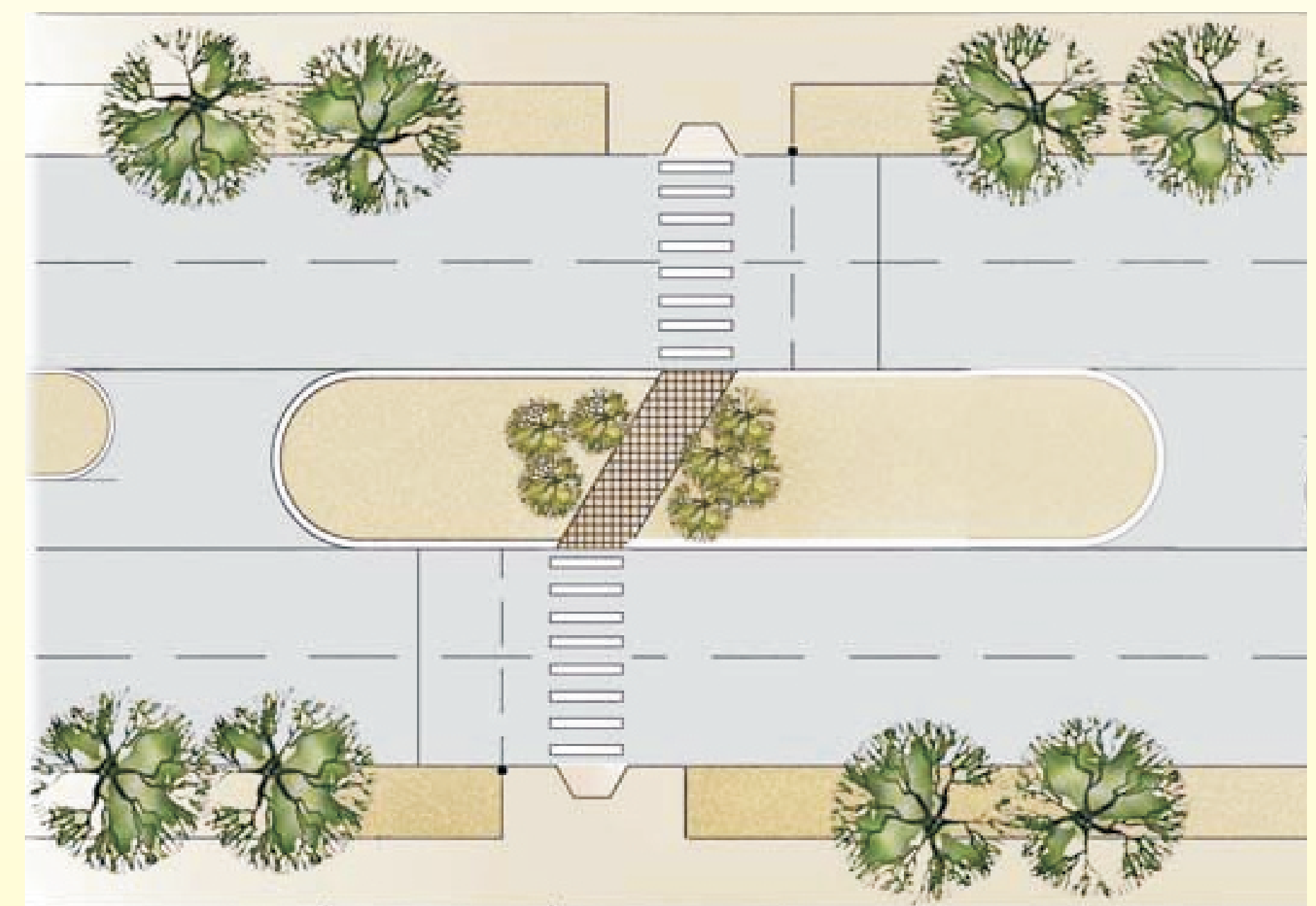

Angled Center Medians

#### RE-EVALUATE INTERSECTION DESIGN / CROSSWALK WIDTH

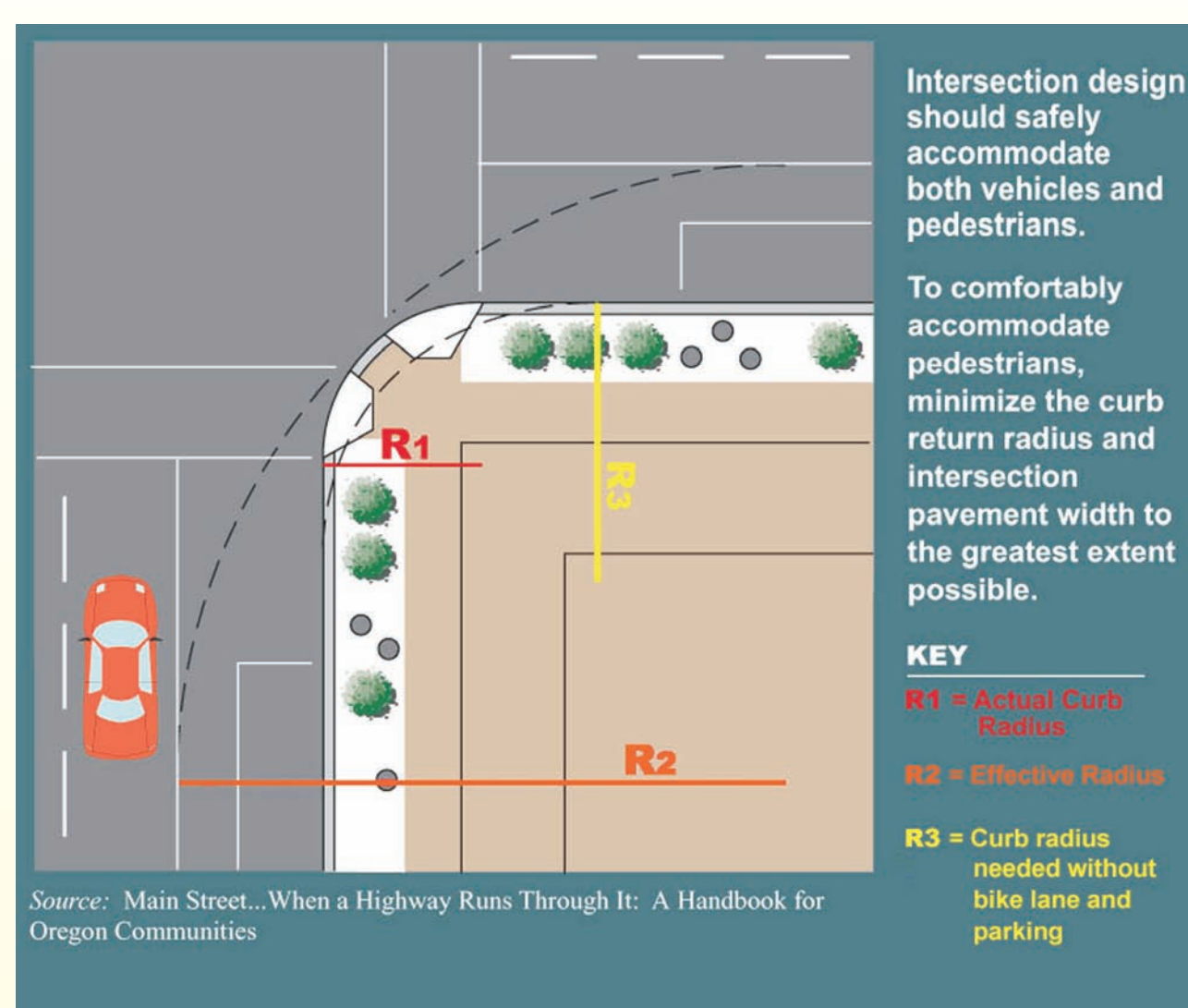

PBIC Image Library

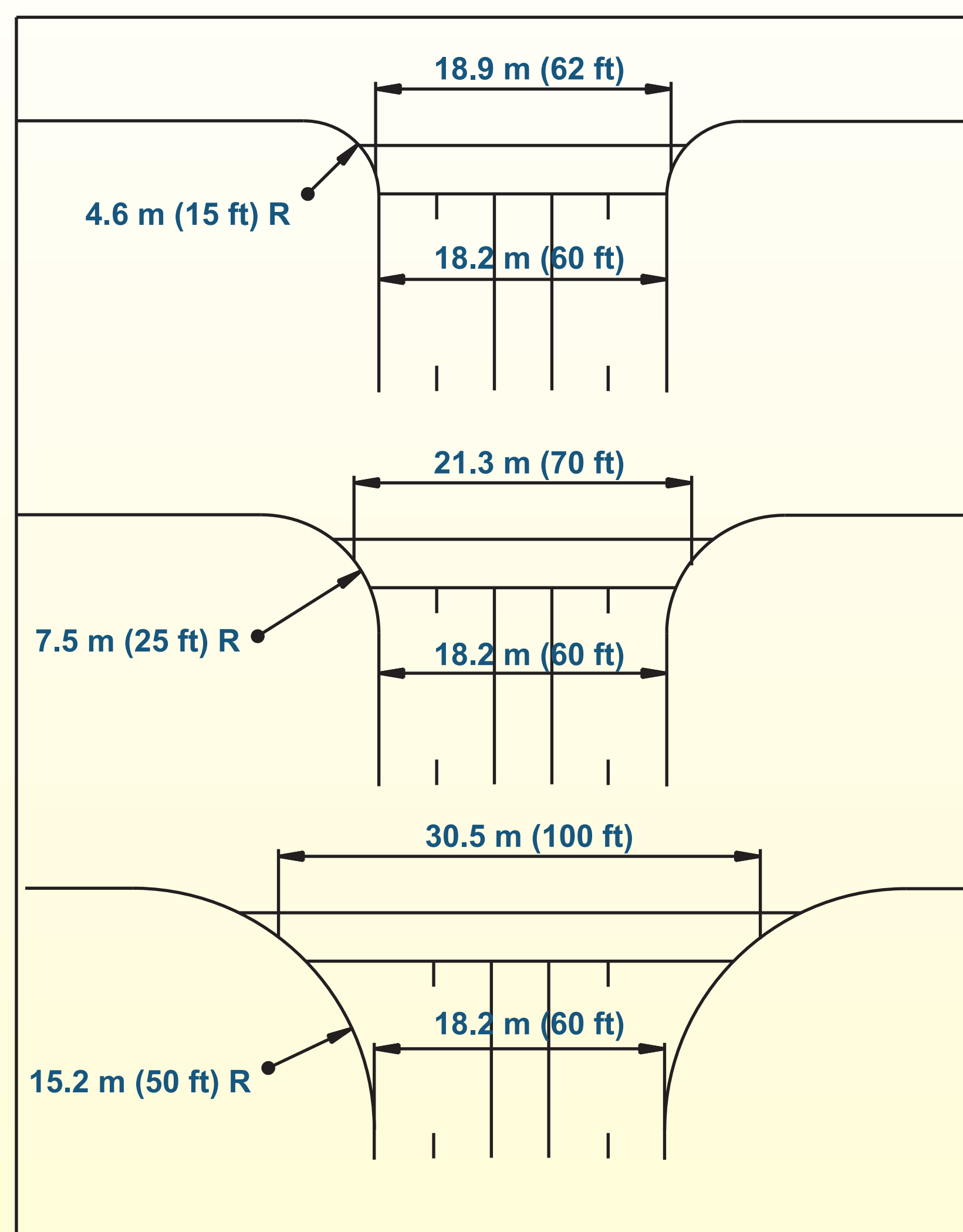

Reduced Crossing Lengths

#### RE-EVALUATE BICYCLIST SAFETY / MOBILITY



Buffered / Two-way Bicycle Lanes

*Where could these items help you?*